



# 8800 MODEL

CONTEMPORARY ALUMINUM

Stylish aluminum frames  
with full-view glass



*8800 Clear anodized aluminum, clear tempered glass*



*8800 Black anodized aluminum, white laminated privacy glass*

## 1 choose your style:

Full-View doors with equal panel spacing are designed to complement your home's clean, modern look.

Check with your dealer before purchasing doors to make sure you choose the right frame to match your window choice. If you are ordering a 16' or wider door, as well as a single door, ensure that the door frames match.

### Light-Glass Frames

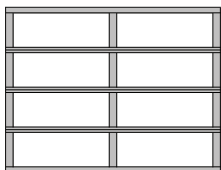

8' and 9' Wide (2 panel)

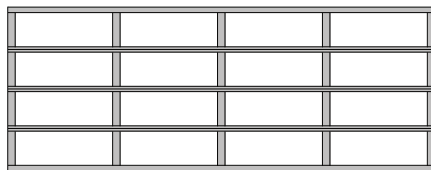

16' Wide (4 panel)

### Heavy-Glass Frames

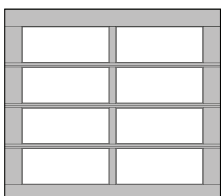

8' and 9' Wide (2 panel)

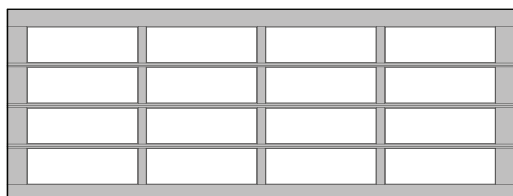

16' Wide (4 panel)

Due to the weight of this door, it is only offered in the double reinforced frame.

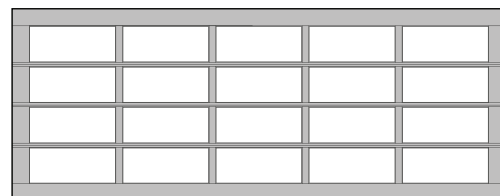

18' Wide (5 panel)

**Special order only**

Panel spacing drawings shown are for illustrative purposes only and do not reflect actual stile and rail dimensions. If double reinforced frame is ordered, other doors must be ordered from that grouping to match and may incur an additional upcharge. See dealer for details.





8800 Dark bronze anodized aluminum,  
custom bronze laminated glass

## 2 choose your color:

### Anodized Finish

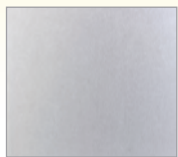

Clear  
(Standard)

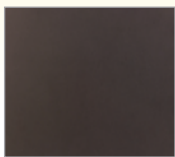

Dark Bronze  
(Optional)

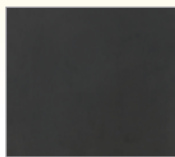

Black  
(Optional)

### Paint Finishes (optional)



White



Brown

### Powder Coat Finishes

Select from 188 powder coat color options to best match your home.



Actual color may vary slightly from brochure due to fluctuations in printing process.  
Color samples are available by request through your local Wayne Dalton dealer.





8800 Bronze 40% gloss aluminum, white laminated privacy glass

### 3 choose your glass:

A wide variety of glass colors, tints, and styles are available. Most panel styles are also available in both single pane and insulated configurations.



1/8" Clear Glass



Green Tinted



Gray Tinted



Bronze Tinted

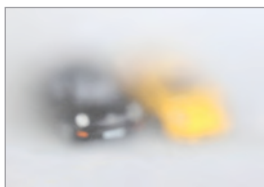

Satin Etched



White Laminated



Obscure



We also offer multi-wall polycarbonate in Clear, White, Bronze in lieu of glass. See your Wayne Dalton Dealer for details.

# stylish. colorful. contemporary.

Wayne Dalton Full-View doors are constructed with a **rugged, anodized aluminum frame** and with equal panel spacing. The design makes the doors very **easy to maintain.**

## performance features



- **Tongue and Groove Joints** provide a great weather barrier.
- **Flexible Vinyl Bottom Seal** helps prevent dirt and elements from entering your garage.
- **Reinforcing Fins** along with heavy-duty track and brackets to provide years of smooth, trouble- free operation (The fins are the extruded part of the door section that are not visible through the glass.)



**Aluminum rails and stiles** are designed with clean edges and straight lines to create a true contemporary style.

8800 Clear anodized aluminum, clear tempered glass

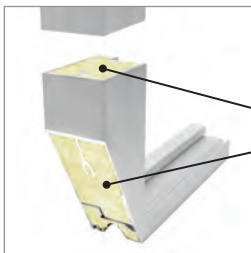

**Optional polyurethane insulation** adds R-value\* of up to 4.36

Polyurethane filled rails and stiles

R-values of Insulated 8800	9x7 door	16x7 door	9x8 door	16x8 door
1/2" insulated glass Solar Ban 70XL argon filled (R=3.125)	4.36	4.36	4.23	4.23
1/2" insulated glass (R=1.75) with polyurethane filled rails and stiles	3.18	3.17	3.02	3.02
1/2" insulated glass Low E (R=2.38) with polyurethane filled rails and stiles	3.73	3.71	3.59	3.58



Model 8800 offers a five year limited warranty on the aluminum and one year limited warranty on the glass. See full text of warranty for details.

\* Wayne Dalton uses a calculated door section R-value for our insulated doors.



BEFORE



AFTER



8800 Clear anodized aluminum,  
white laminated  
privacy glass

# Garage Door Design Center

[www.Wayne-Dalton.com](http://www.Wayne-Dalton.com)

Go to Wayne-Dalton.com today and click on Design Center. Here you can upload a photo of your home and experiment with panel designs, color options, window styles and hardware designs. Instant curb appeal awaits with just the click of your mouse!



SOLD AND DISTRIBUTED BY:

2501 S. State Hwy 121 Bus., Ste 200  
Lewisville, TX 75067  
[www.wayne-dalton.com](http://www.wayne-dalton.com)

© 2015 Wayne Dalton, a Division of Overhead Door Corporation. Consistent with our policy of continuing product improvement, we reserve the right to change product specifications without notice or obligation. Item 336356 5M 3/15 JAR